

2. Installing the VESA Adaptor

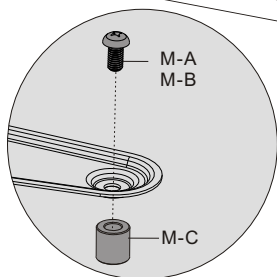
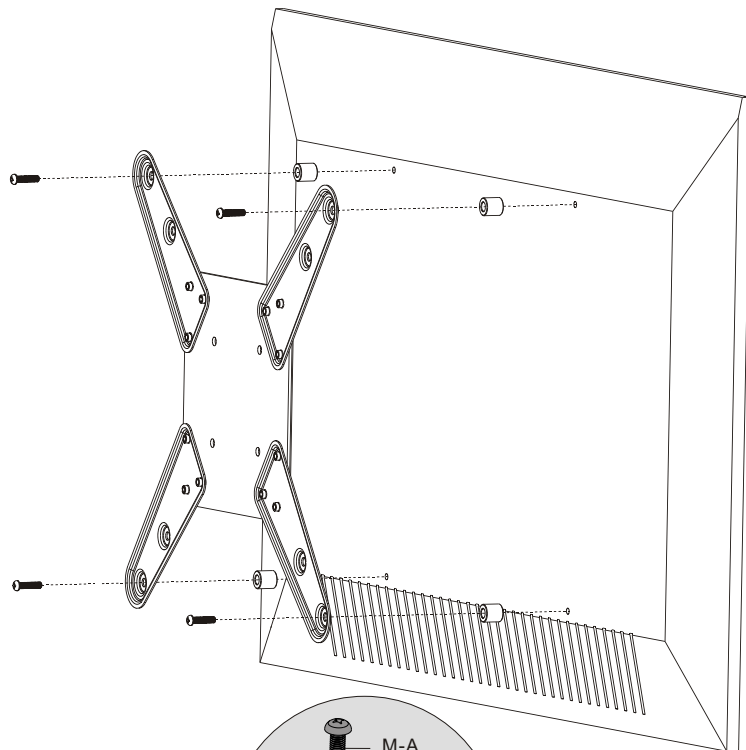
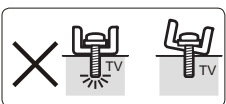
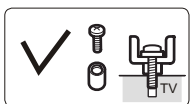

Note: Choose the appropriate screws, washers and spacers (if necessary) according to the type of screen.
• Screw the VESA adaptor onto the display.

⚠ Tighten all screws but do not over tighten.

Maintenance

- Check that the bracket is secure and safe to use at regular intervals(at least every three months).
- Please contact your distributor if you have any questions.

VESA Adapter

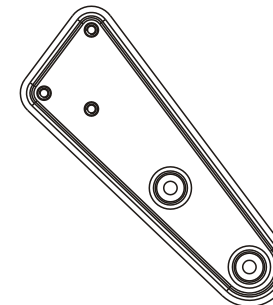
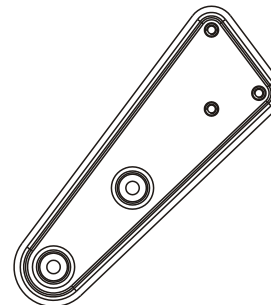
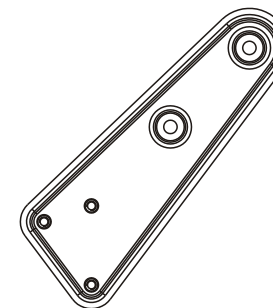
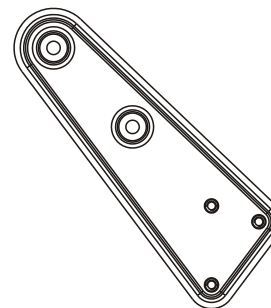

CAUTION: DO NOT EXCEED
RATED LISTED WEIGHT. SERIOUS
INJURY OR PROPERTY DAMAGE
MAY OCCUR!

LCD-201K



300x300
400x200
400x400



NOTE: Read the entire instruction manual before you start installation and assembly.

⚠ WARNING

- Do not begin the installation until you have read and understood the instructions and warnings contained in this installation sheet. If you have any question regarding any of the instruction or warning, please contact your local distributor.
- This mounting bracket was designed to be installed and utilized **ONLY** as specified in this manual. Improper installation of this product may cause damage or serious injury.
- Never exceed the maximum load capacity.
- Tighten screws firmly, but do not over tighten. Over tightening can damage the items, greatly reducing their holding power.
- This product is intended for indoor use only. Using this product outdoors could lead to product failure and personal injury.

Component Checklist

IMPORTANT: Ensure that you have received all parts according to the component checklist prior to installing. If any parts are missing or faulty, telephone your local distributor for a replacement.

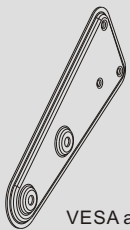

VESA adaptor (x2)
A

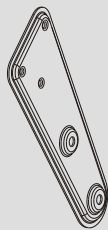

VESA adaptor (x2)
B



M6 (x8)
C

Package M



M6x30 (x4)
M-A



M8x30 (x4)
M-B



big spacer (x4)
M-C

1. Attaching the VESA Adapters to the Mounted Head plate

The VESA adaptor is only compatible with VESA 200x200 flat mounted head.

1a For VESA 400x400/300x300

Unit: mm

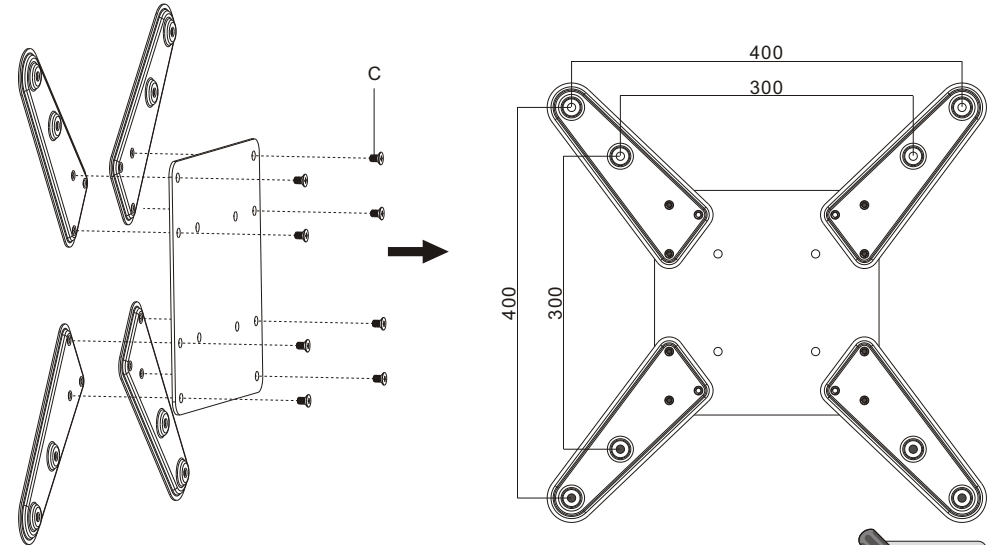

1b For VESA 400x200

Unit: mm

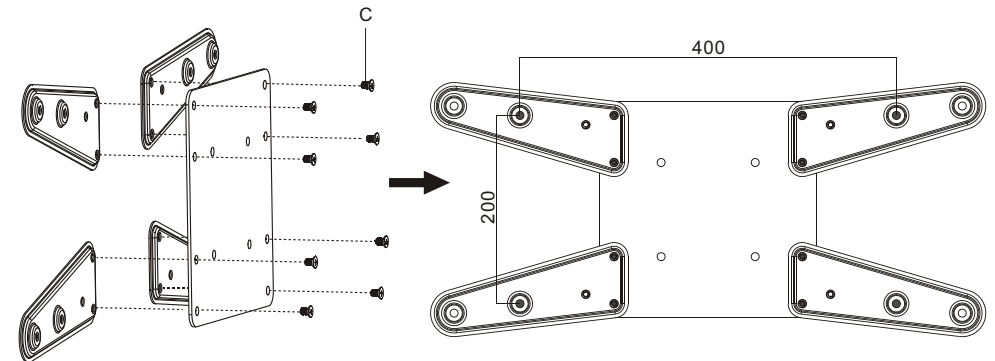

Attach the VESA adaptor to the mounted head using the appropriate screws so that the hole pattern can be extended to Max VESA 400x400.



Tighten all screws but do not over tighten.